**Warning!**

Be sure to read and fully understand this document before installing, operating, your Stazz product. Failure to do so can result in item failure, property damage, or serious injury. Item failure, injury or property damage due to improper installation is not covered by warranty.

**MAXIMIZE SPACE,  
MINIMIZE EFFORT.**

## STEP 1 - Install the Aluminum Slide Rails

Using the provided Drill Template (K), align it to the correct height (H) and depth (D = 15mm) on both the left and right interior cabinet panels. Mark the drill hole positions as shown in the diagram.

Figure 1

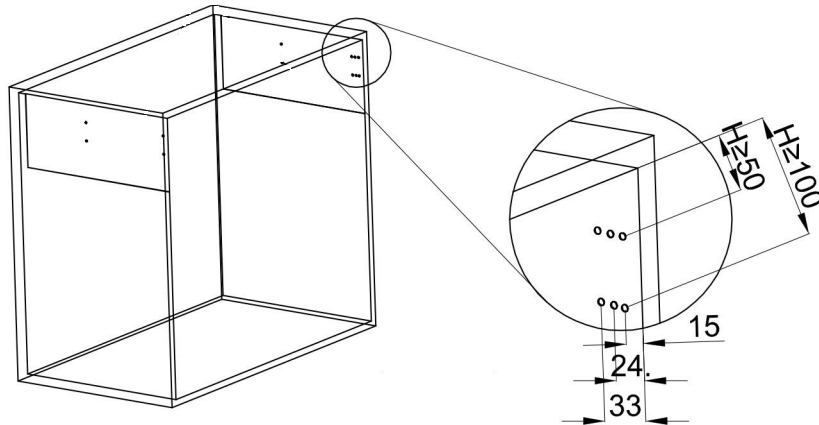

## STEP 2 - Assemble the Frame

Join the left and right slide boxes (B, C) with the front aluminum tube (D). Secure loosely using M4\*8 screws (F) to allow for width adjustment.

Figure 2

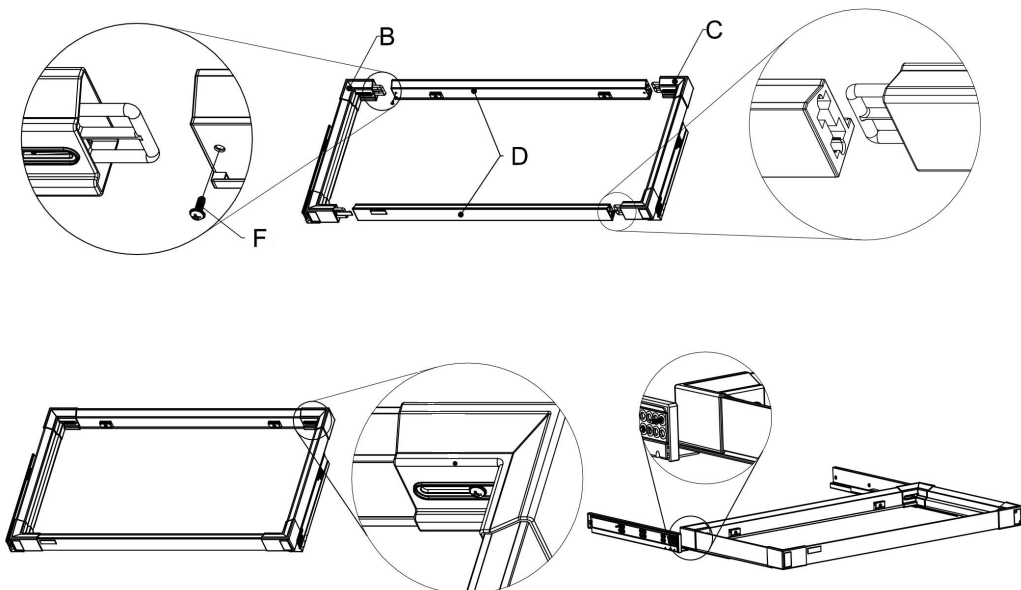

## STEP 3 - Install the Slide Frame

Pull out the assembled frame and position it inside the cabinet, aligning it with the previously marked holes.

Fix the frame using ST4\*16 screws (G).

Then attach the slide covers using the additional ST4\*16 screws on each side.

Figure 3

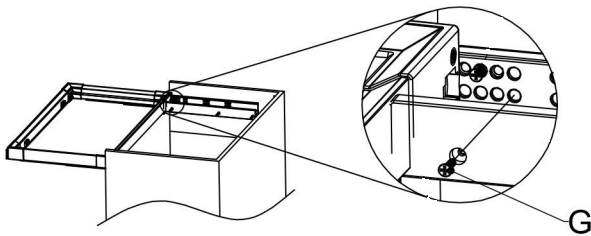
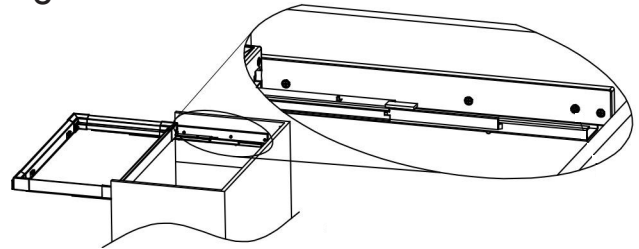

Figure 3.1



## STEP 4 - Complete Assembly

Insert the rack into the frame as shown.

Test the sliding motion to ensure smooth operation.

Figure 4

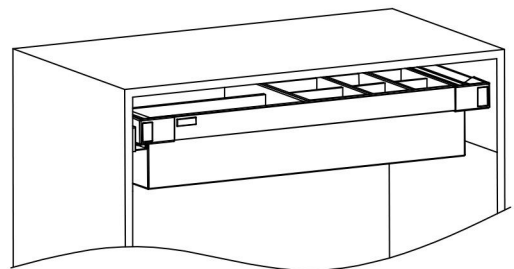
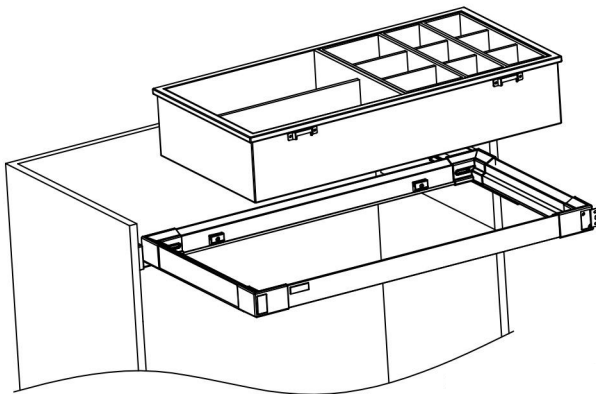

## STEP 5 - Optional: Install the Door Panel

If desired, attach a cabinet door by securing it to the mounting bracket using the included hardware.

Figure 5

