**Warning!**

Be sure to read and fully understand this document before installing, operating, your Stazz product. Failure to do so can result in item failure, property damage, or serious injury. Item failure, injury or property damage due to improper installation is not covered by warranty.

**MAXIMIZE SPACE,
MINIMIZE EFFORT.**

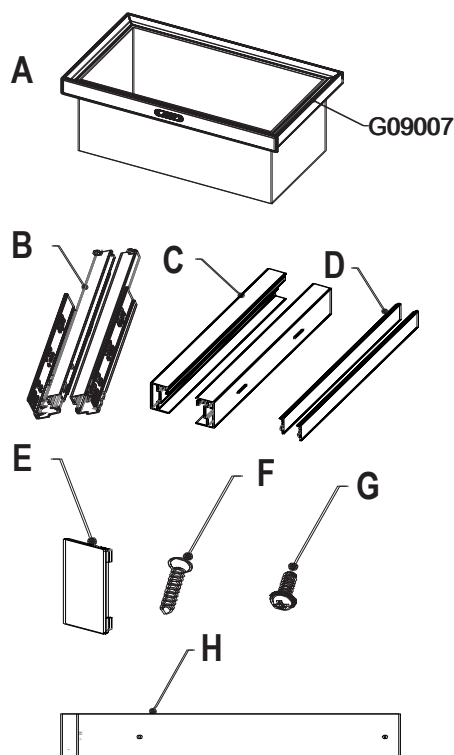

LIST OF PARTS		
No.	Quantity	Description
A	1 pcs	G09007
B	1 pcs	Soft close slides (left, right)
C	2pcs	Slide aluminum
D	2pcs	Slide aluminum tube cover
E	2pcs	Slide aluminum tube decorative cover
F	4 pcs	ST4X16 countersunk head tapping screw
G	4 pcs	M4X8 round head screw
H	1 pcs	G0900 Series Install paper mold

Product Specifications

Product width W, height H, depth D469

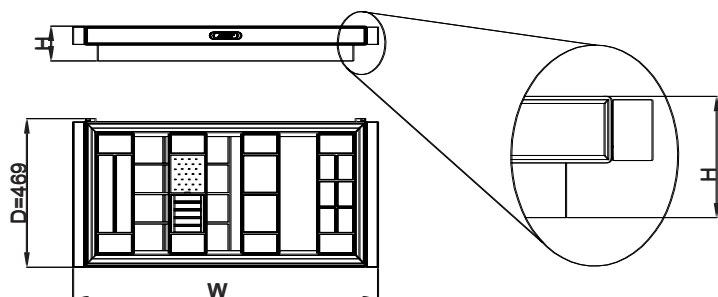

Product Specification	Width (W)
D	764

Item No.	Height (H)
G09007	280

Installation requirements:

Dimension of cabinets: Inner width (W) in the table, height (H1) in the table, recommendation inner height (H2) in the table, inner depth (D) ≥ 480 .

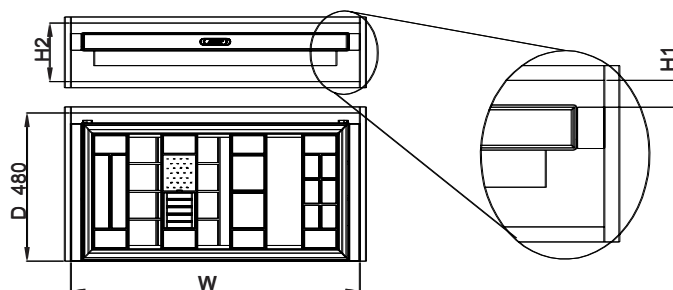

Item No.	Inner Width (W)
D	764

Item No.	H1	H2
G09007	≥ 50	≥ 380

STEP 1 - Install the Aluminum Slide Rails

Refer to the diagram and mark positioning lines inside the cabinet according to the installation specifications.

Align the aluminum slide rail tightly along the marked line and secure it using the provided ST4X16 (F) screws.

Figure 1

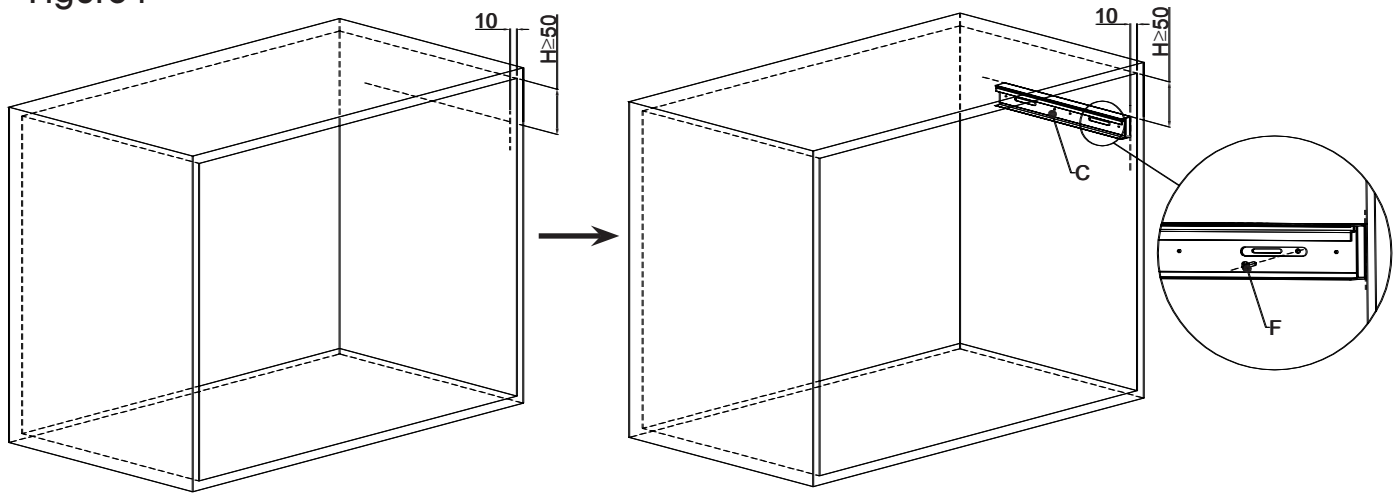

STEP 2 - Install the Slides

Insert the slide (B) into the mounted aluminum slide rail (C) as shown in the diagram. Secure the slide in place using the provided M4X8 screws (G).

Figure 2

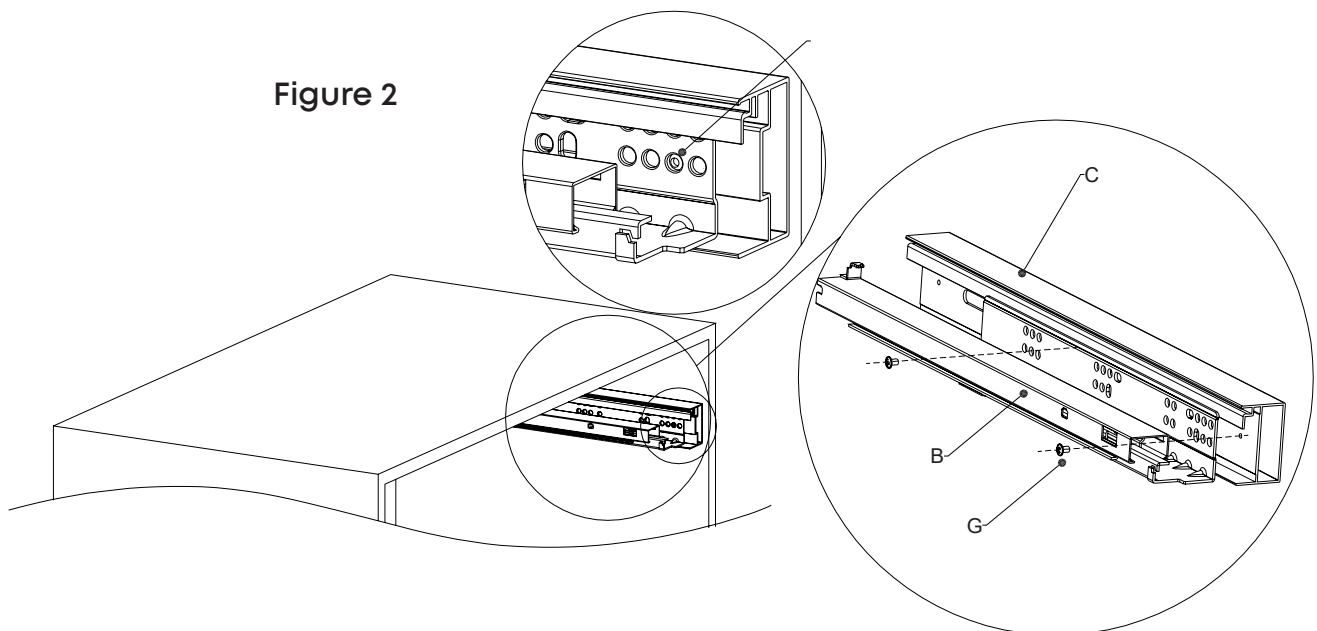

STEP 3 - Install the Frame

Pull the slide (B) outward, then carefully position the frame (A) onto the slide. Push the frame inward until you hear a "click" — this indicates the quick-release mechanism has securely engaged.

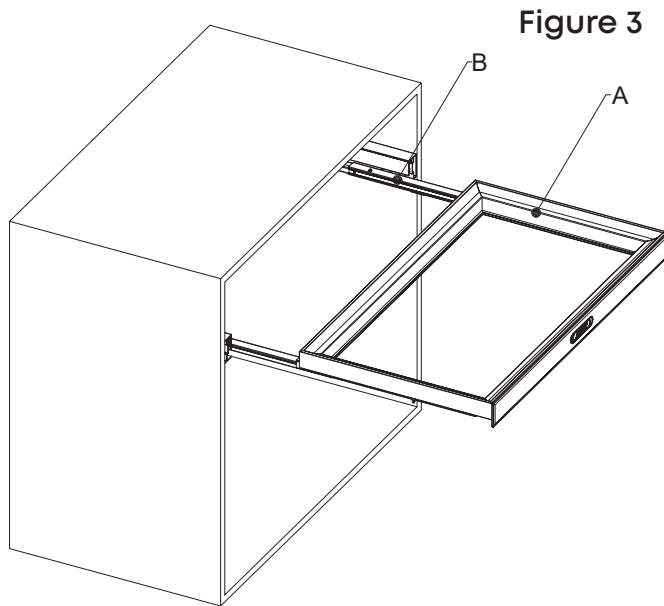
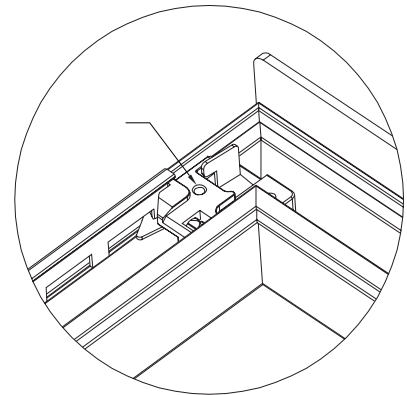

Figure 3.1



STEP 4 - Finalize Installation

After confirming the frame is securely installed, insert the aluminum tube cover (D) into the slide aluminum tube.

Figure 4

